



# PC\*MILER Navigator 450

All-In-One GPS for Truck Drivers



Quick Start Guide

# Getting Started

## Thank you for choosing PC\*MILER Navigator.

This Quick Start Guide will help you get on the road quickly with your PC\*MILER Navigator. We'll explain all the basics, and include shortcut page references to the main User Guide, which you'll find on [www.pcmnav.com](http://www.pcmnav.com)

### 1. Checklist

Check the contents of your box, box should contain:

- PC\*MILER Navigator with Pre-installed CoPilot Truck GPS Navigation Software
- QuickStart Guide
- User Manual
- Windshield Mount
- Truck Charger
- Mini USB Cable



PC\*MILER Navigator



Quick Start Guide  
and User Manual



Mini USB Cable



Windshield  
Mount



Truck  
Charger

# Getting Started

## 2. To Assemble the Windshield Mount

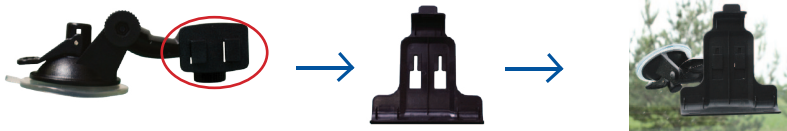

- Attach clip to mount.
- Place mount against windshield.
- Before attaching to windshield ensure lever is in unlock position (away from suction cup toward clip).
- Put suction cup on windshield and press lever into lock position (**down** toward base of mount) to secure.



### WARNING!

Please check state and local traffic laws before mounting. Minnesota state laws prohibit drivers from using suction mounts on their windshields while operating a motor vehicle.

# Getting Started

## 3. To Attach the Truck Charger



- Connect USB end of charger to the USB port on the PC\*MILER Navigator.
- Connect opposite end into truck power port.
- **NOTE:** Unit should remain plugged in and powered at all times.



### FOR YOUR SAFETY

This product contains a lithium-ion battery. To prevent damage, remove the unit from the vehicle when exiting or store it out of direct sunlight.

# Getting Started

## Identification

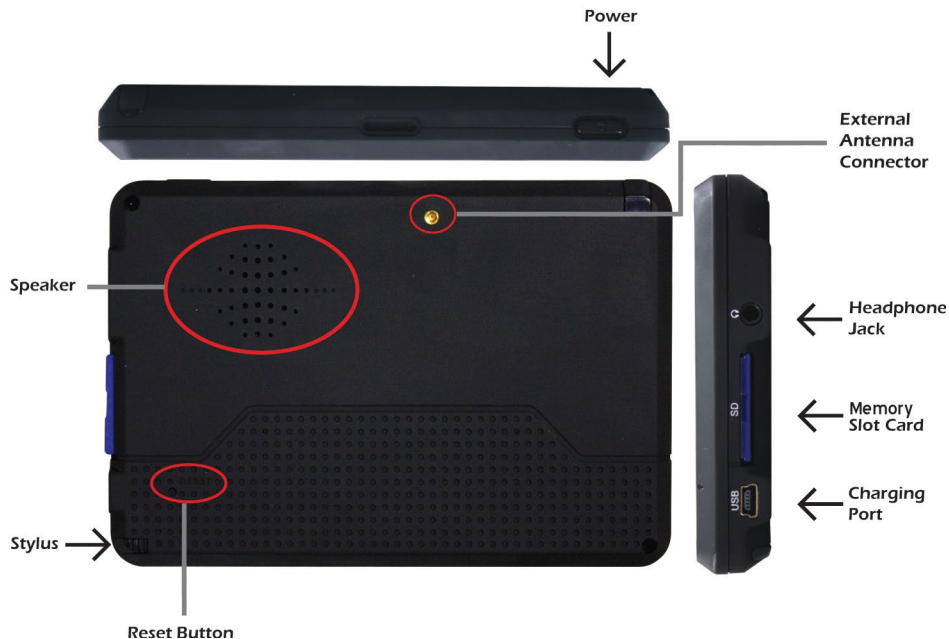

# Getting Started



## FOR YOUR SAFETY

It is your sole responsibility to use the product in a safe and responsible manner. You must obey local traffic laws, posted road signs and safety regulations. Do not operate the product while driving.

### 4. Select Language and Voice

- Tap the desired language on-screen text.
- Tap **Frank** to have street names read aloud and tap **Continue**. (See page 47 in the user manual for additional language and voice options)

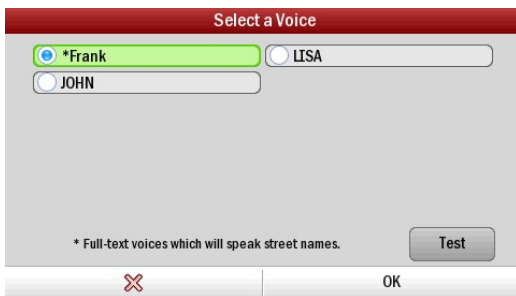

### 5. Set Units of Measure

- Choose desired units of measure by tapping between English and Metric. (See page 48 for additional units of measure options)

# Getting Started

## 6. Select Time Zone

- Choose desired time zone by scrolling through the list. Tap **OK**.

## 7. End User License Agreement

- Read the agreement for PC\*MILER Navigator, Powered by CoPilot Software. Tap **Accept or Decline** after reading. (See page 74-80 of the user manual for EULA)

## 8. Tips and Tricks

PC\*MILER Navigator is full of great features. To help you get to know them, we have included Tips and Tricks when you launch your PC\*MILER Navigator the first time.

### How to Scroll

- Read how to scroll and tap



### Routing - Dimension

- To change personalized routing dimensions, tap desired dimension > enter dimension > tap **Save**.
- Continue entering personalized routing dimensions and tap



Routing - Dimensions		
Max Height	Max Width	Total Length
13 ft 6 in	96 in	48 ft
Total Weight	Total Weight / Axle	
80000 lbs	0 t	
✕	←	→

# Getting Started

## Routing - Hazmat

- Select personalized hazmat routing options and tap



## Routing - Tolls

- Select personalized toll preferences and tap



## Routing - More

- Select personalized routing preferences such as Scenic Route, National Network, 53ft Trailer, Override Restrictions, and International Borders Open then tap



## Save Profile

- This step is OPTIONAL - To save profile enter a profile name and tap check box.



## Warning

Read warning and tap **Accept.**

# Getting Started

## Tips: GPS Signal

GPS Signal will be limited inside buildings, tunnels, or parking garages. To work effectively the PC\*MILER Navigator should be mounted on the supplied windshield cradle for clear line of sight to the sky. **\*CAUTION:** it is illegal in Minnesota to attach anything to the windshield.



**You are now ready for your first trip!**

# First Trip

## Selecting a Destination

PC\*MILER Navigator uses GPS Satellites to calculate your exact position so you don't have to enter your starting point. Simply enter your destination and PC\*MILER Navigator will take you there, providing detailed dock-to-dock voice guided instructions.

- Tap **Menu > Destination > Address**.
- Enter the city/town name or zip code of your destination.
- Scroll through the list by gently pressing the stylus to the list and do not remove pressure. Then move the stylus up and down to scroll the list.
- Tap the correct city or area when it appears in the list below the city field.
- Enter the first three or four letters of the street name (Do not enter house/building number, you will enter this on the next step). Autofilled addresses will appear below. Select the correct street name when it appears.
- Enter the house/building number and tap **GO**.
- See pages **13-15** in the main User's Guide.

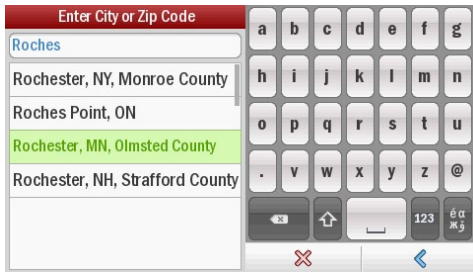

# First Trip

## Quick References

There's more you can do when entering your destination and setting off. Here are some helpful page references for the main User Guide:

Plan a trip with **multiple destinations, waypoints** or **optimize** your trip.

- Entering Multiple Destinations  
See pages **27**
- Setting Waypoints  
See pages **29-30**
- Optimizing Stops See page **33**

Set and **Save Home, Work, and Favorite addresses** for quick and easy destination entry.

- Tap **Menu > My Places > Home** See page **19**
- Tap **Menu > My Places > Work** See page **19 - 20**
- Tap **Menu > My Places > Favorite** See page **20**



# First Trip

PC\*MILER Navigator offers a number of standard PC\*MILER commercial truck **route types** such as Practical, Economic, shortest, and National Network. Additionally routing **options** such as .53 Foot Trailer, Heavy/Light Vehicle, Toll Roads, International borders Open, and Hazmat are available.

- See page **67-70** in main User Guide
- See page **71** in main User Guide for PC\*MILER Navigator Routing Type Chart



## FOR YOUR SAFETY

Do not attempt to change the settings, or set a destination on the PC\*MILER Navigator while driving. Ask a passenger to make changes, or pull over safely. Do not leave your device loose in the cab while driving. Ensure it is correctly placed in the windshield mount.

## Tip: What are These?

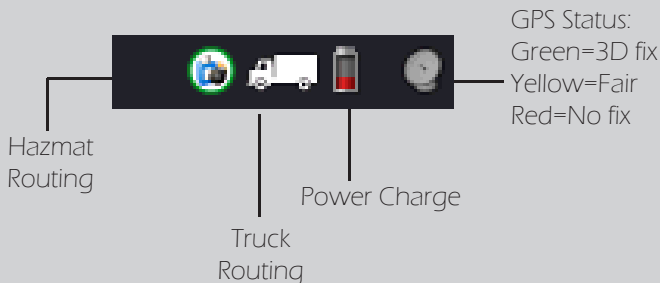

## Change the Driving View

PC\*MILER Navigator can be customized to meet your individual needs and style. You can choose from six different screen driving views. To access

- Tap **Menu** > > **Driving Views** or tap the  (driving views shortcut button) to quickly access one of the four views.
- See pages **35-38** in the main User's Guide.

# On the Move

## Take a Detour

PC\*MILER Navigator can detour from your current itinerary. You can choose an alternate route, or just detour around a section of the route.

- Select **Menu > Detour**
- See pages **25 -26** in the main User's Guide.



## Search for a Quick Stop Point of Interest

If you are running low on diesel fuel or need to rest at a truck stop, PC\*MILER Navigator has millions of pre-loaded Points-of-Interest (POI) to search.

- Tap **Menu > Quick Stop**
- From the list, select a category. For example **Truck Services**.
- See page **23-24** in the main User's Guide.



# Support

## Software Support

For any software related problems, please send an e-mail to [techsupport@alk.com](mailto:techsupport@alk.com) or call **408-916-9128**. For any map or routing problems, please e-mail [data@alk.com](mailto:data@alk.com) and provide as much detail as possible.

## Hardware Support

For any hardware issues, relating to accessories or the unit itself: Please e-mail [pcmnavhwsupport@alk.com](mailto:pcmnavhwsupport@alk.com) OR call **507-226-0042**.

**Our support team is available Monday to Friday  
9:00am to 5:00pm EST.**

**Emails will be answered within 1-2 business days.**

## Alternatively

Visit the support section at <http://support.alk.com> for additional FAQs and contact details.

## Register you CoPilot

You should register your PC\*MILER Navigator solution at [www.alk.com/register](http://www.alk.com/register) to receive information about the CoPilot Truck navigators software.

# PC\*MILER Navigator 450

TECHNOLOGY THAT DRIVES TRANSPORTATION™

Copyright © 2010. ALK Technologies, Inc. All rights reserved.

